



# DL85

**Watertight LED downlight for bathrooms, accommodation and public areas**

The **DL85** from LightPartner is a compact, watertight LED downlight designed for wet areas, bathrooms, and accommodation zones on board. Encased in durable aluminum and sealed with a clear or opal polycarbonate cover, it provides warm, glare-free illumination with high color fidelity. Slim and easy to install using spring clips, it fits ceilings up to 35 mm deep and becomes IP55-rated when used with ceiling material. With selectable beam angles and brightness levels, optional decorative rings, dimming controls, and emergency-backup configurations, the DL85 brings elegant, reliable lighting to maritime interiors.

## Technical Details

Possible combinations of features and other options available on request. Please contact us for more information.

|                           |  |
|---------------------------|--|
| Luminaire Type            | Downlight  |
| Input Voltage             | 230 VAC / 110 - 240 VAC / 24 VDC                       |
| Area                      | Indoor   |
| Application               | Cruise / Offshore / Naval / Commercial                 |
| Frequency                 | 50-60 Hz / 0 Hz  |
| Wattage                   | 1x 6 W / 1x 12 W                                       |
| Lumen Output              | 550 lm / 750 lm / 850 lm / 1200 lm                     |
| Color Temperature         | 3000 K / 4000 K / 5700 K / 6500 K / Red / Green / Blue |
| CRI Color Rendering Index | 80 / 90  |
| Beam Angle                | 20° / 40° / 60°  |
| Control Mode              | Switchable / Dimmable / DALI                           |

|                           |                            |
|---------------------------|----------------------------|
| Cover / Diffusor          | Polycarbonate clear / opal |
| Material of Housing       | Aluminium                  |
| Color of Housing / Ring   | RAL / NCS colors / chrome  |
| Type of Light Source      | LED                        |
| Light Source Included     | Yes                        |
| External Wiring           | Cable 300 mm               |
| Type of Connection        | Plug 3-pole / 5-pole       |
| Mounting Type             | Springs                    |
| IP Class                  | IP20/55                    |
| Ambient Temperature in °C | -25 ... +45                |
| Cut Out in mm             | 68 mm                      |
| Features                  | Black baffle               |

Images

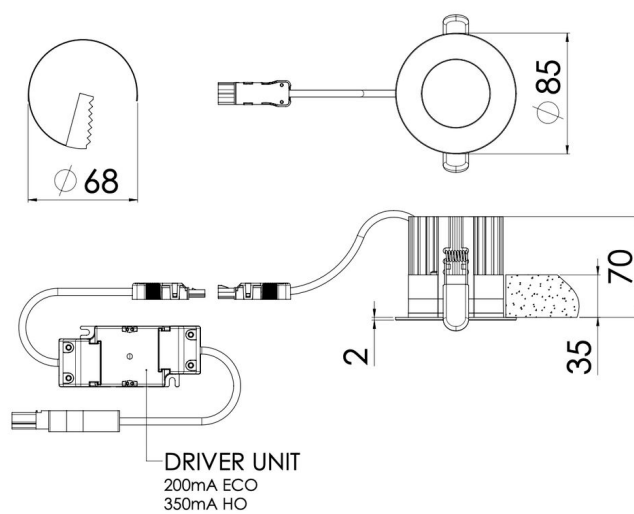

[mm]